

Retail Space for Lease



Kelly Gray, CCIM
 937-470-3002
 KGray@equity.net
 www.equity.net

Main on Main Center
531 S Main St
Englewood, OH 45322

- 25,000 sq ft building (divisible) on 8+ acre lot
- Located on major State Route:
 Daily Traffic Count — 22,000 CPD
- Located in growing community with consistently “Excellent” rated school system
- Adjacent to Englewood MetroPark providing fishing, hiking, horseback riding and bicycling activities
- 1 mile from I-70
- Located less than 2 miles from Samaritan North Health Center



Current view



Demographics:

| Population | Average Household Income |
|-----------------|--------------------------|
| 1 Mile - 6,009 | 1 Mile - \$ 58,442 |
| 3 Mile - 31,887 | 3 Mile - \$ 75,780 |
| 5 Mile - 64,50 | 5 Mile - \$ 72,104 |



“The information submitted herein is not guaranteed. Although obtained from reliable sources, it is subject to errors, omissions, prior sale and withdrawal from the market without notice.”



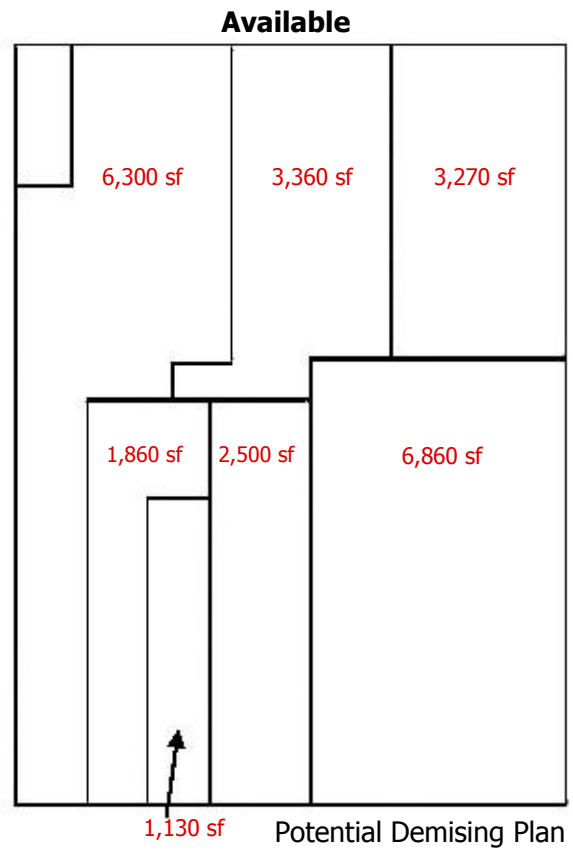

**25,000 sq. ft. Building located
on 8+ acres!**

Can Subdivide

Building size— 187' X 146'